

Appendix A

Site Location Plan

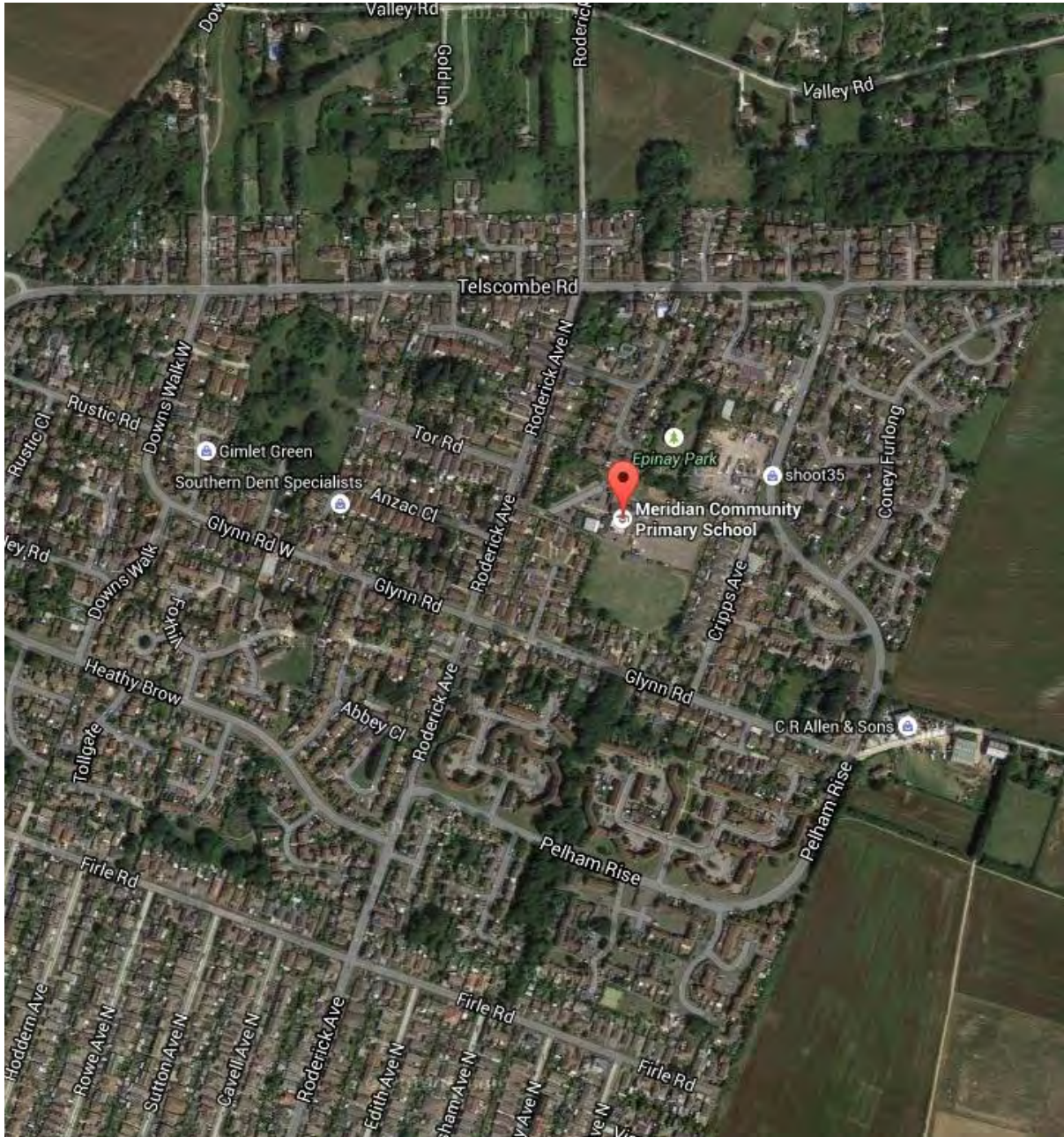

Appendix B

Development Proposals

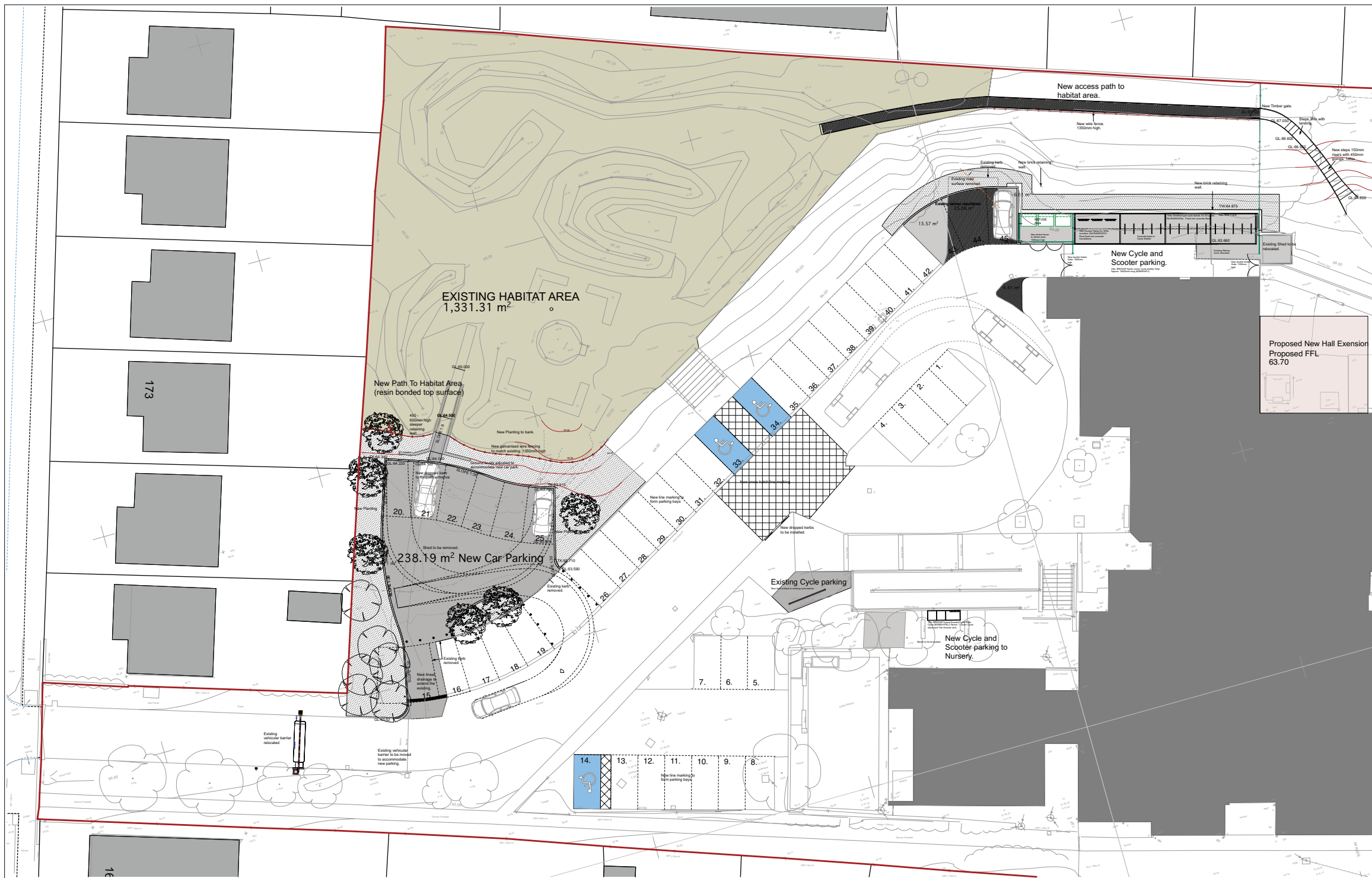

Proposed new car parking. Scale 1:200.

NOTES

Proposed Car Cycle Parking Provision

1. Existing; Total 38No spaces.

Provided as follows:

33 No staff
2No Visitors
3No Disabled.

2. New provision; Total 45No spaces.

Proposed as follows:
(ESCC parking standards, Class D1 Use):
1 Space / 1 Teaching staff.
1 Space / 3 Non-Teaching Staff.
- plus 2No visitor spaces.
- plus 1 space for each disabled employee plus 2 disable spaces or 5% of total capacity, whichever is greater.

School predicted staffing numbers:

1. Full time teaching staff (or equivalent):
21 Teachers plus
4 head/asst heads (includes SENco.) plus
4 nursery Teachers.
Total 29.

2. Full time non-teaching staff (or equivalent):
15 Teaching assistants, plus
6 Individual needs assistants, plus
3 midday supervisor assistants, plus
4 office and
5 kitchen staff.
Total 33.

Proposed Car Parking provision
29No. for teaching staff, plus
11No. for Non teaching staff.
2No. for Visitors
3No. for Disabled.
Total 45, (7No additional parking spaces)

Note: 9No. new spaces created, (2No. lost to accommodate new provision.)

Proposed Cycle parking Provision

(ESCC parking standards, Class D1 Use):
1/10 (62) full time or equivalent staff = 7No cycle spaces.
1/15 pupils (630) = 42No. cycle spaces or scooter parking.
Nursery children 1/15 pupils (26) 2No cycle spaces or scooter parking.

Proposed Provision:
Main School - 7No cycle spaces for staff. (5 existing).
Nursery Pupils - 1no Junior Cycle stand, 10No scooter parking.
School Pupils - 30 no cycle spaces plus min. 20 No scooter spaces.

KEY

- New Macadam Surface
- New soft landscaping
- Existing macadam resurfaced
- Existing macadam and kerbs removed.
- New path - Resin bonded aggregate surface.

REVISION DATE	DESCRIPTION
A 22.4.2016	Alternative B approved, cycle parking added.



The Old Library
Albion Street, Lewes, East Sussex BN7 2ND
email: info@mackellarschwerdt.co.uk
tel: 01273 480608
fax: 01273 480688

STATUS:

CLIENT: Emcor UK Ltd.

PROJECT NAME: Peacehaven Schools Feasibility

LOCATION: Peacehaven

DRAWN BY: SK

CHECKED BY: SG

SCALE: 1:200, 1:100, 1:1100

SHEET SIZE: A1

DRAWING TITLE: Option 2 Proposed New Car parking

DRAWINGS:

This office is licensed to reproduce Ordnance Survey maps onto drawings but anyone doing so must ensure that this use is acknowledged by displaying the following on all copies of all paper maps:
© Crown copyright. All rights reserved. Licence number AR 100006739

NOTES

This drawing is Copyright and shall not be produced nor used for any other purpose without the written permission of the Architects.

Do not scale this drawing.

The Contractor is responsible for checking all dimensions on site.
Report any discrepancies, errors or omissions to the Architects immediately.

The Contractor shall ensure that all goods, materials and workmanship conform with current British Agrement Certificates, British Standards and Building Regulations, and ensure that all works are executed in full compliance with all current Codes of Practice and Regulations in respect of Health & Safety.

DRAWING NUMBER:
8830 / 25 A

